

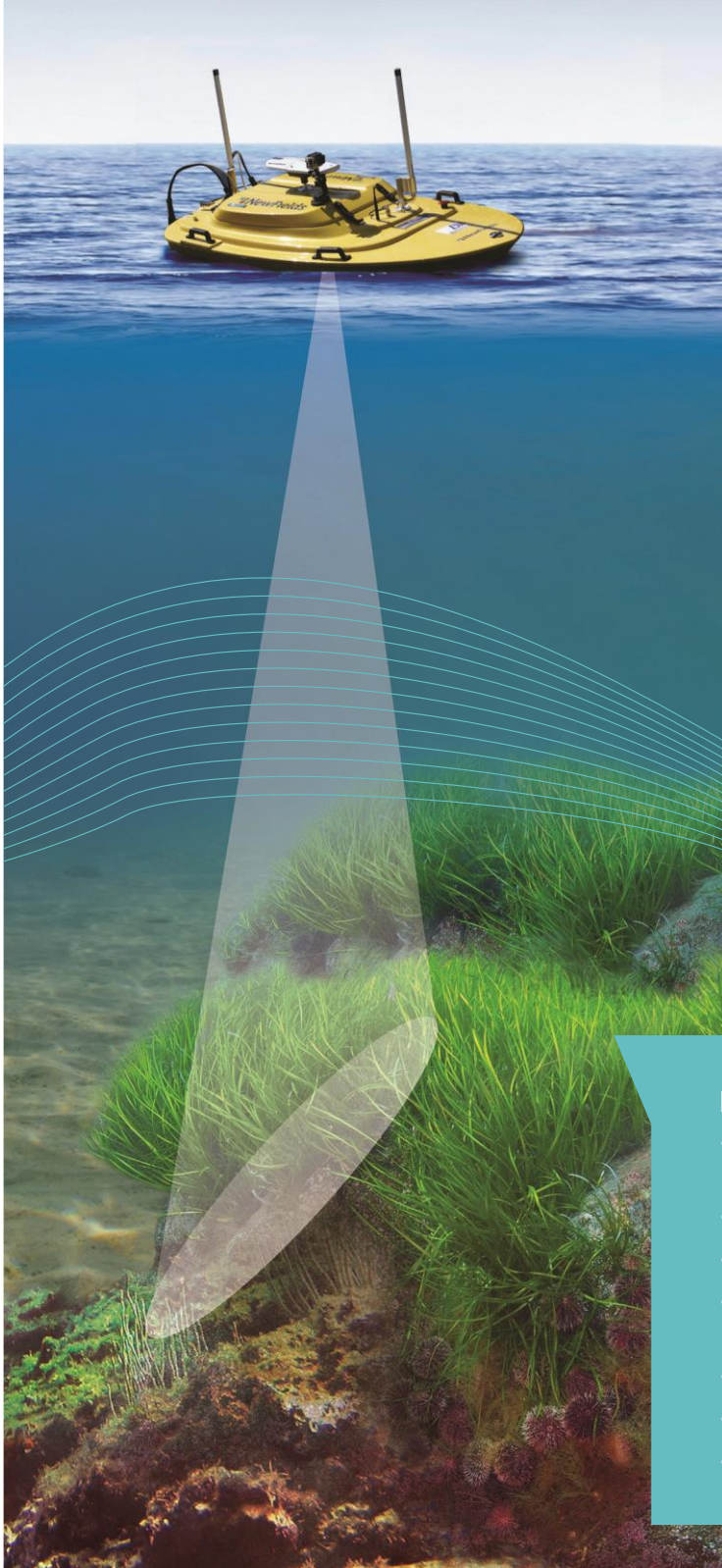

AQUATIC HABITAT ECHOSOUNDER

OEM VERSION FOR USVs AND ROVs



Assessment and Mapping of Submerged Aquatic Vegetation

- Map eelgrass and other habitat areas
- Track invasive aquatic weeds

Substrate Classification

- Delineate areas of sand, mud, rock

Bathymetric Surveys

- Accurately quantify volume
- Generate contour profiles



Dimensions

- Echosounder Unit: 25.7cm x 15.2cm x 7.8cm
- (10.1 in x 6.0 in x 3.1 in), Weight 1.81 kg (4 lbs)

Performance Features

- Compact electronics package ideal for small, remote-operated vessel payloads
- Ethernet communication
- Precision instrument, calibrated and highly accurate
- Includes software for data acquisition, processing and visualization
- GENERATE MAPS QUICKLY AND EASILY
- Integrated DGPS to georeference data
- High resolution, full color echogram



AQUATIC HABITAT ECHOSOUNDER

OEM VERSION FOR USVs AND ROVs

Echosounder Specifications

- Transmit Power: 105 Watts RMS
- Input power: 12-18 VDC
- Draw: 6 Watts, Fuse: 2 Amp DC
- Transmit source level: 213 dB re 1uPa
- Pulse length: 0.4ms
- Ping rate: 5Hz
- Range resolution: 1.7cm
- Accuracy: 1.7cm +/- 0.2% of depth
- Depth range: 0-100m
- Operating conditions: 0-50 °C
- GPS Ready

Transducer

- Frequency – 200 kHz
- Beam angle – 9. degree conical
- Low side lobes to -18 dB
- Seamless, SEALCAST™, urethane housing

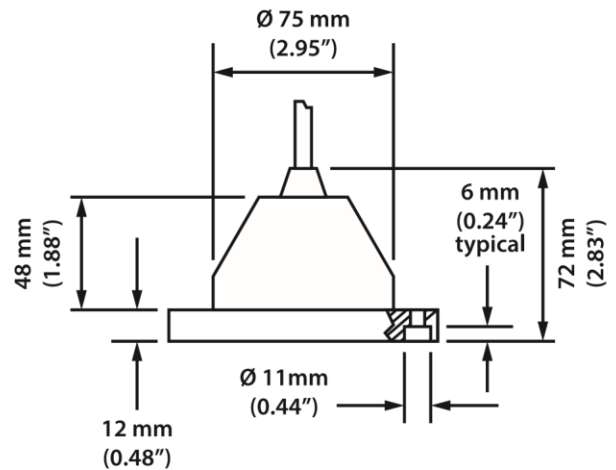

Interfaces

- 1 x Ethernet (system control)
- 1 x RS232 DB9 (GPS in)
- 2 x BNC (Trig In/Out – TTL)

Visual Habitat_{MX}

Software Features

- Fast, user friendly mapping tools
- SAV – canopy height, % cover, biomass
- Bathymetry – produce accurate depth charts
- Substrate classification
- Export results as CSV, KML or Shapefile

